

FLINT CULTURAL CENTER ACADEMY

Flint Cultural Center Corporation



K-12 EDUCATION



OWNER

Flint Cultural Center Corporation



LOCATION

Flint, Michigan



COST

\$20 Million



SIZE

78,000 SF

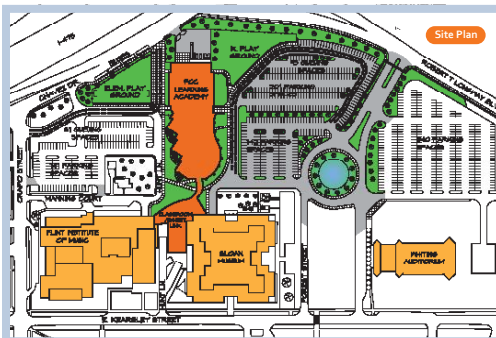

THE SOLUTION

This 48-acre Flint Cultural Center campus houses Fine Arts, Music, Science, History, Performing Arts and Drama, as well as the largest Planetarium in the State of Michigan.

By strategically placing the new charter school within close proximity to the Sloan Museum of Discovery and the Flint Institute of Music, the new school could be physically linked to the two most heavily accessed Cultural Center facilities, allowing these resources to be easily accessible to the new school's students and staff without leaving the interior of the building.

OVERVIEW

The Flint Cultural Center Academy is a new 78,000 SF, 650 student, K-8 Charter School designed to change the learning outcomes of disadvantaged children. Ridway White, CEO of the Mott Foundation, understood that not all children learn alike and that children thrive in flexible educational environments where multiple learning and teaching styles such as hands on learning techniques, small group interaction, and teaming are incorporated into the day to day operations.

After years of dreaming and planning for a measurably more successful future for children in Flint and the surrounding community, it was determined to locate the new school on the campus of one of Flint's long standing assets, the Flint Cultural Center.

FAST TRACK SCHEDULE

With a construction budget of \$20 Million and an aggressive schedule, the design was approved two days before Christmas in 2017, giving the THA team only 5 months to take the site plan and one line floor plans from concept to final construction drawings and only 13 months for the general contractor to complete the 78,000 SF school.

MAIN STREET

The excitement begins at the exterior 40 foot tall cantilevered entrance canopy set atop a sleek, two story building of glass and metal panels that leave behind the traditional models of brick and block and introduce the community to a 21st century, urban expression. Upon entering the building, bold colors and dramatic elements lead you down Main Street, with views of the gym and the cafeteria to the right and to the left, a giant-sized Learning Stair that draws students up to the glass enclosed Innovation Center on the second floor.

LEARNING STAIRS

The learning stair is a 22 foot wide, stepped auditorium seating space designed to accommodate large student gatherings. Complete with audio and video capabilities, as well as phone charging stations and internet access, students can comfortably sit or recline on the broad treads for small social gatherings, large group interaction and/or presentations and instruction. [READ MORE](#)

817 East Kearsley St.
Flint, Michigan 48503



P: 810-767-5600
F: 810-767-1650



info@tha-flint.com
www.THA-Flint.com



FLINT CULTURAL CENTER ACADEMY

Flint Cultural Center Corporation

PAGE 2: CONTINUED ▶

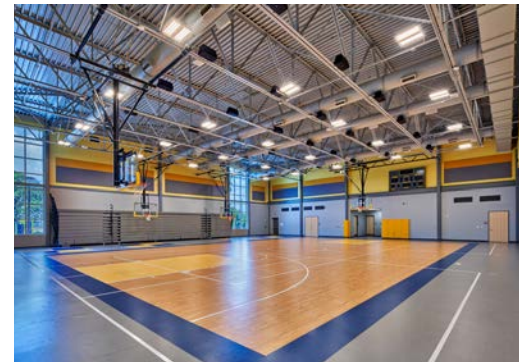

MICROSOFT INNOVATION LAB

The Microsoft Innovation Center is a drop-in technology lab, equipped with state-of-the-art technology and software to support the exploration of unique learning opportunities such as CAD, modeling, animation, school video production and more. The Flint Cultural Center Academy is one of only three US Microsoft Flagship Schools in the entire United States.

CLASSROOM CLUSTERS

To further enhance the flexible learning environment, the school's classrooms were designed in clusters, which can be easily adapted to address different teaching techniques and learning styles. Each cluster contains three classrooms equipped with moveable tables and flexible furniture separated by moveable walls and a central team room. The moveable walls can be opened to allow interaction between all three rooms, with students moving throughout the entire space, or closed to create three individual learning spaces, per the required curriculum. The team rooms are complete with storage cabinets to house classrooms supplies and also contain conferencing furniture, serving as a separate space for students to complete team work or project based learning activities.

THE LINK

The link portion of the project (Phase 2) allows students and staff to travel to the Sloan Museum of Discovery and the Flint Institute of Music without ever going outside. This is most critical during cold winter days and in bad weather. Ramps were used to create a smooth transition between the differing levels of grade when traveling between facilities and the creation of a small Learning Stair serves as collaborative learning space for studying, presentations, or relaxing with friends. The link houses 8th grade classrooms and the Learning Stair is to be shared with the Sloan Museum and the Flint Institute of Music for their programs as well.

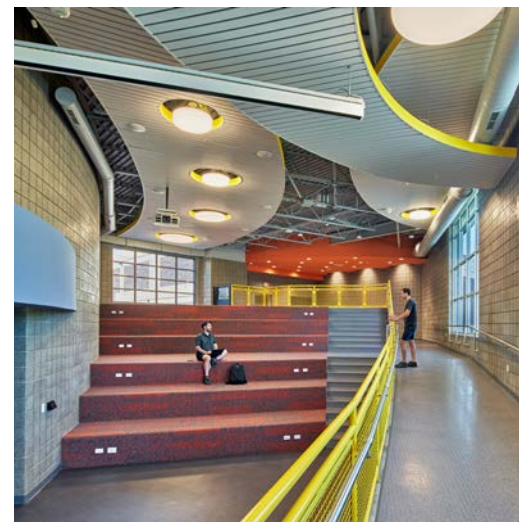

817 East Kearsley St.
Flint, Michigan 48503



P: 810-767-5600
F: 810-767-1650



info@tha-flint.com
www.THA-Flint.com



K-12 EDUCATION